

Soils Map

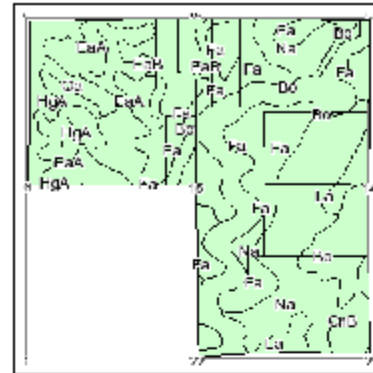

State: South Dakota
County: Douglas
Location: 015-098N-063W
Township: Independence
Acres: 462.2
Date: 1/12/2012

Fsa borders provided by the Farm Service Agency as of May 23, 2008.
 Soils data provided by USDA and NRCS.

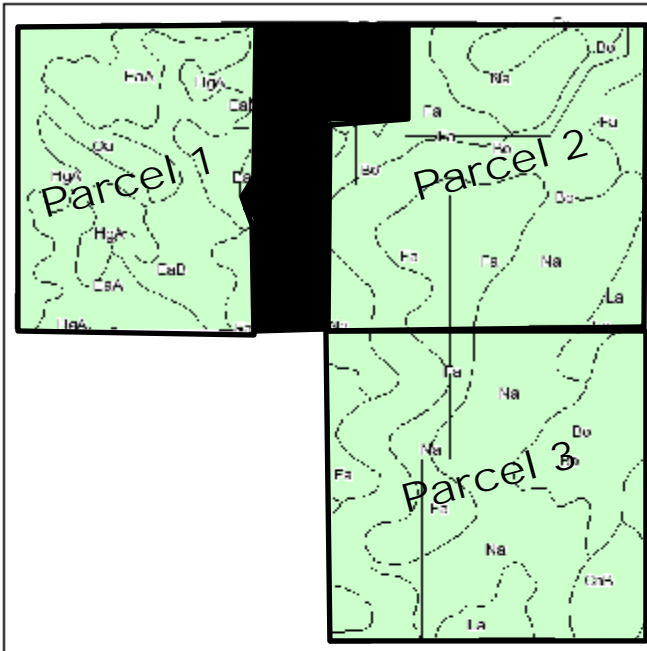

Maps provided by:

©AgriData, Inc 2008
 www.Agridatainc.com

Code	Soil Description	Acres	Percent of field	Non-Irr Class	Productivity Index	Alfalfa hay	Brome grass alfalfa	Com	Flax	Grain sorghum	Oats	Soybeans	Spring wheat	Tall wheatgrass
Na	Napa silt loam	106.4	23.0%	Vlw	37	0.8	1.4	35				8		
Bo	Bon loam, channeled	90.7	19.6%	Vlw	37									
Fa	Farmworth silt loam	90.1	19.5%	IVs	35	2	3.2			36	42		17	
HgA	Higmore-Walke silt loams, 0 to 3 percent slopes	61.3	13.3%	IIIs	85	2.7	4.5	55		60	64			
EaA	Eakin-Ethan complex, 0 to 3 percent slopes	45.4	9.8%	IIe	84	2.7	4.5	53		58	60		26	
EaB	Eakin-Ethan complex, 3 to 6 percent slopes	33.5	7.3%	IIe	79	2.7	4.5	51		55	57		25	
La	Lane silty clay loam	14.6	3.2%	IIIs	84	2.8		53		54	70		28	4
CnB	Clamo-Ethan-Prosper loams, 1 to 6 percent slopes	10.9	2.4%	IIe	76	2.8	4.7	58	16	55	64			
Oa	Orita silt loam	7.1	1.5%	IIc	91	3.1	5.2	66		67	70		31	
CsA	Clamo-Stickney-Prosper loams, 0 to 3 percent slopes	2.1	0.5%	IIIs	80	2.9	4.8	60	19	58	67			
CnA	Clamo-Ethan-Prosper loams, 0 to 3 percent slopes	0.1	0.0%	IIe	80	2.9	4.8	60	19	58	67			
Weighted Average					54.2	1.6	2.5	28.7	0.5	29	31.9	1.8	9	0